



LIFEPAK[®] CR2 TRAINER

Operating Instructions



Contents

Getting Started	5
Unpacking and Inspecting the Trainer	5
Initial Setup.....	5
Controls, Indicators, and Labels	6
Outside Controls, Indicators, and Labels	6
Inside Controls and Features	8
Running the Default Scenario	12
Entering Setup Mode	13
Modifying Training Scenarios	16
Setup Options	17
Language List.....	23
Using the Trainer	24
Simulating "Device Not Ready" Status	25
Shutting Down the Trainer	25
Troubleshooting Tips	26
Caring for the Trainer	28
Replacing Training Electrodes	28
Replacing Batteries	29
Cleaning the Trainer.....	30
Recycling Information.....	31
Accessories and Replacement Parts	32

Software Updates	32
Installing Software Updates	32
Troubleshooting Tips for Software Updates	35
Specifications	36
Symbols	36

Getting Started

The LIFEPAK CR2 Trainer provides a way for trainees to practice responding to a simulated cardiac arrest event. The Trainer simulates the voice prompts and features of the LIFEPAK CR2 defibrillator, but does not deliver shocks.

The Trainer is equipped with 2 preset training scenarios. These scenarios can be easily customized using the setup screen on the Trainer to provide a wide variety of training options.

Unpacking and Inspecting the Trainer

1. Remove the Trainer and examine the outside for signs of damage that may have occurred during shipping.
2. Check the remaining contents in the shipping box against the sales order.
3. The Trainer ships with 4 D cell batteries installed. See Outside Controls, Indicators, and Labels (on page 6) for battery compartment locations.

Initial Setup

The general steps below provide an overview of the process you will follow to prepare the Trainer for use. Detailed instructions for each step are provided in this manual.

1. Open the Trainer lid and confirm the device turns on.
2. Remove the electrode tray to access the setup screen.
3. Set up Scenarios 1 and 2 according to your preferences or local protocols. These scenarios can be changed at any time, if desired.
4. If the Trainer will not be used immediately, turn it off by pressing the POWER button for at least 3 seconds.

Controls, Indicators, and Labels

This section describes the controls, indicators, and labels on the device.

Outside Controls, Indicators, and Labels

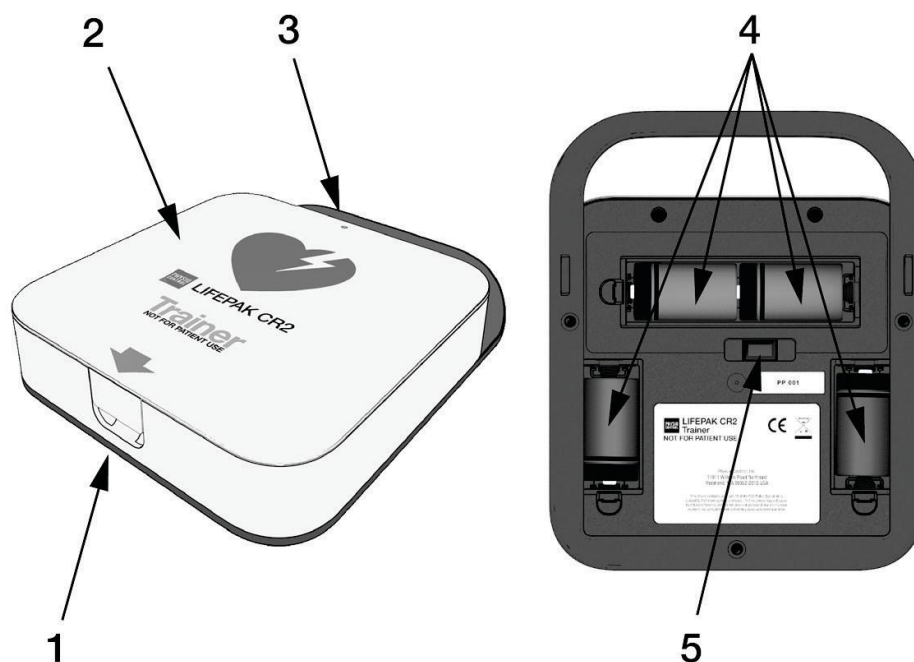



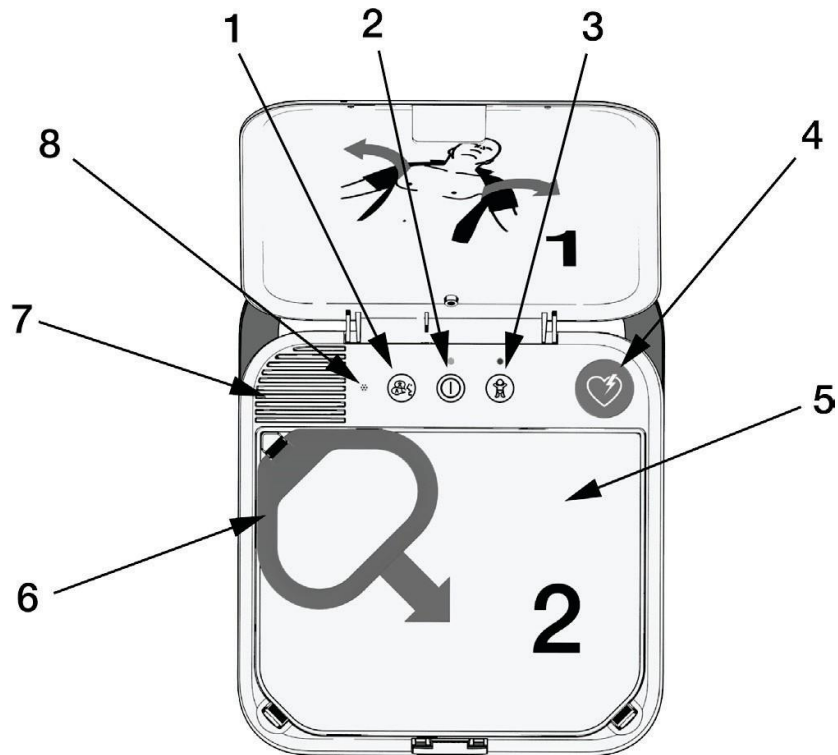

ITEM	FEATURE	DESCRIPTION
1	Latch	To open the Trainer, insert your finger in the recessed area and pull up.
2	Lid	Open the lid to turn the Trainer on.

ITEM	FEATURE	DESCRIPTION
3	Power indicator	<p>The green LED is off when the Trainer is turned off, and on when the Trainer is in use or in Setup mode.</p> <p>The LED turns to steady on when the lid is opened. When in Standby mode with the lid closed, the LED flashes once every 6 seconds. This simulates the behavior of the Readiness indicator on the LIFEPAK CR2 defibrillator.</p> <p>If the POWER button is pressed briefly during a training session to pause the scenario, the LED blinks once every second.</p>
4	Battery compartments	The battery compartments hold 4 D cell batteries.
5	USB port	The USB port is used to install software updates.

Inside Controls and Features



ITEM	FEATURE	DESCRIPTION
1	LANGUAGE button 	During training sessions, press the LANGUAGE button, if prompted, to switch between your preset languages.
2	POWER button 	<p>Press the POWER button to turn the device on. Press and hold for at least 3 seconds to turn the device off.</p> <p>Note: You can also turn the device on by opening the lid.</p> <p>During training sessions, press the POWER button for less than 3 seconds to pause the scenario, and press again to resume.</p>

ITEM	FEATURE	DESCRIPTION
3	CHILD MODE button 	During training sessions, press the CHILD MODE button to switch between Adult mode and Child mode. The green LED above the CHILD MODE button is illuminated when Child mode is selected. Note: The CHILD MODE button is disabled after the electrodes are placed on the manikin.
4	SHOCK button/indicator 	When the Trainer is used to simulate a fully automatic defibrillator, the SHOCK indicator flashes to indicate the Trainer is preparing to deliver a simulated shock. When the Trainer is used to simulate a semi-automatic defibrillator, the SHOCK button flashes to indicate the Trainer is ready to deliver a simulated shock and a voice prompt instructs the trainee to press the flashing button.
5	Reusable electrode tray cover	The cover for the training electrode tray can be removed and replaced repeatedly. To replace a cover that has been removed, align the cover on the tray and press the edges into the groove, starting with the corners.
6	Red handle	Pull the red handle to reveal the reusable training electrodes.
7	Speaker	Provides audio voice prompts and tones.
8	Noise sensor	The noise sensor monitors the noise level of the surrounding area while the Trainer is in use. The Trainer automatically adjusts the volume of the voice prompts so they can be clearly heard. Note: This feature is only active if Volume is set to Auto. See Entering Setup Mode (on page 13) for more information.

Electrode Tray Features

After the red handle is pulled, the electrodes are revealed as shown below.

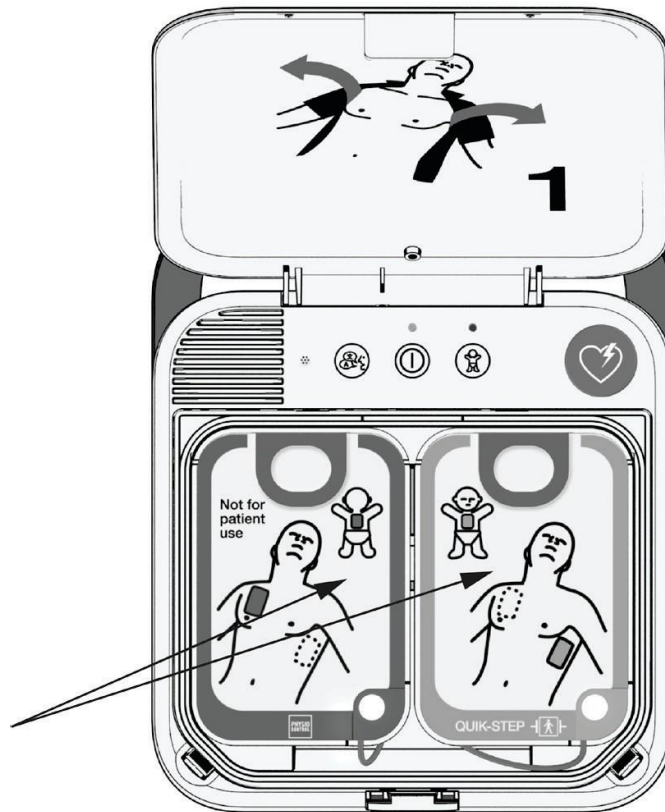

The training electrodes include a sensor that detects when the electrode pads are pressed onto a firm surface such as a manikin. During training sessions, this enables the Trainer to detect when the electrode pads have been placed and automatically continue the scenario.

Note: The Trainer only detects when the electrode pads are first applied. It does not detect pads that become loose or are removed during a scenario.

The training electrodes have reusable adhesive for use on manikins, and can be used approximately 50 times. See Caring for the Trainer (on page 28) for information about replacing the training electrodes.

The training electrode liners can be lifted to reveal the electrode plug, as shown.

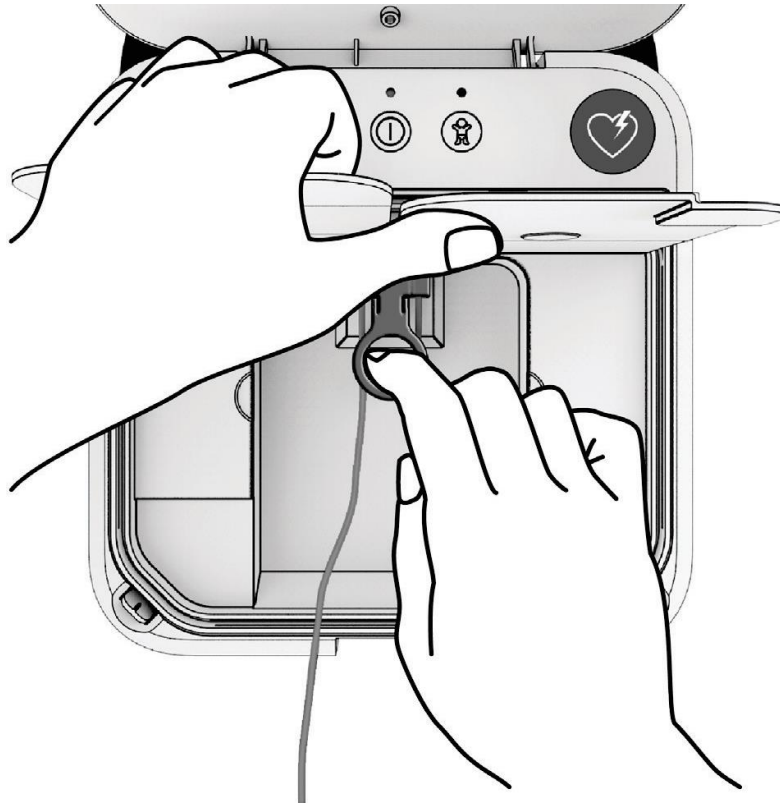

When the electrodes are unplugged and the Trainer lid is closed, the Trainer simulates a LIFEPAK CR2 defibrillator in which the electrode tray is not properly installed. The Power indicator turns off, and the Trainer beeps.

Running the Default Scenario

To run the default scenario, follow these basic steps.

Note: It is not necessary to turn the Trainer on before you begin.

1. Start with the lid closed. Open the lid to turn the Trainer on and begin the scenario.
2. Follow the voice prompts. You can pause the scenario at any time by pressing the POWER button for less than 3 seconds. Press again to resume the scenario.
3. When you are instructed to place the electrode pads on the manikin, be sure to press the center of the pads firmly. This enables the Trainer to detect when the electrode pads have been placed and automatically continue the scenario.
4. Continue to follow the instructions until the scenario ends or you decide to stop.

Note: To stop without powering off the Trainer press the POWER button for less than 3 seconds.

5. Prepare the Trainer for the next use.
 - Place the electrode pads back on the liners.
 - Coil the electrode wire neatly and store it under the liners.
 - Reseal the electrode tray cover, starting from the corners.
 - Close the lid.
6. When the lid is opened, the same scenario will start at the beginning.

Entering Setup Mode

Setup Mode allows you to customize the two preset scenarios to meet your training needs. To access the setup screen and enter Setup Mode, remove the electrode tray as shown in the following illustrations.

Note: Voice prompts will begin as soon as you open the lid. The voice prompts stop when you remove the electrode tray.

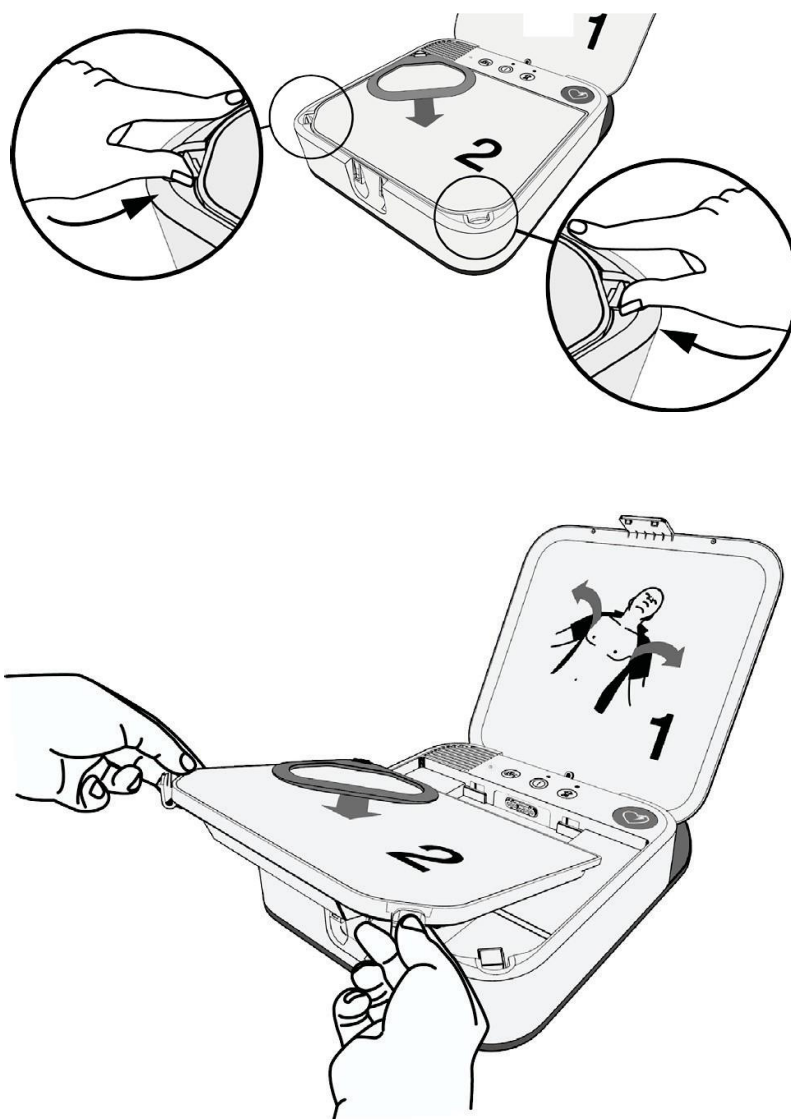

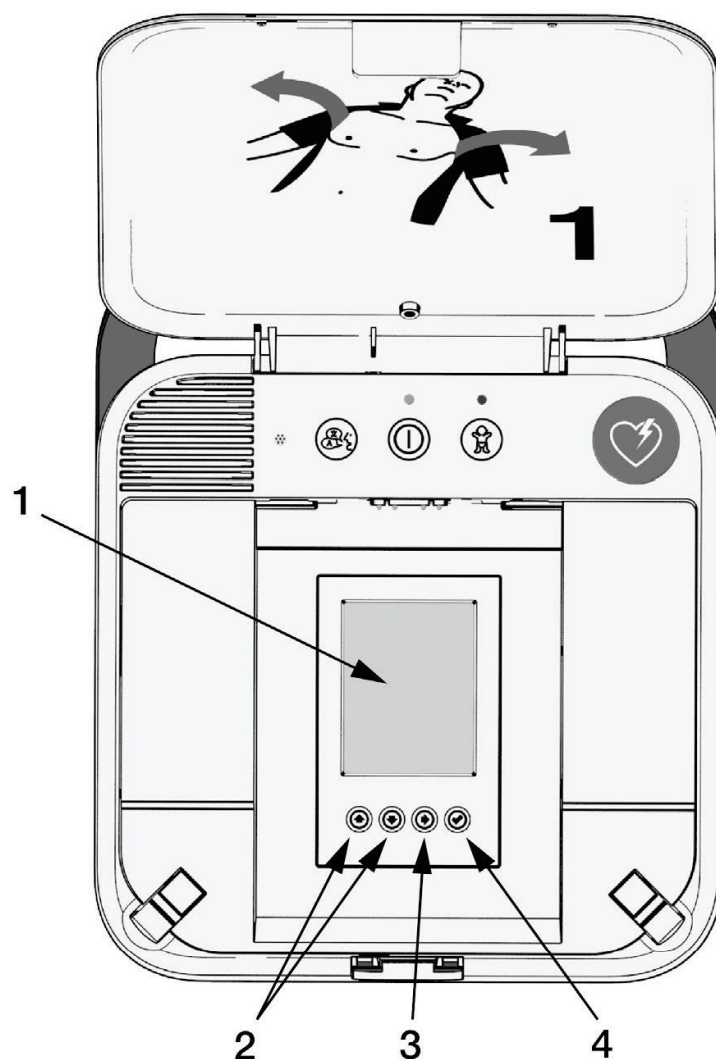

When the electrode tray has been removed, the setup screen and buttons will be exposed as shown in the following illustration, and the setup screen will turn on automatically. If the Trainer is turned off, press the POWER button to turn on the setup screen.



ITEM	FEATURE	DESCRIPTION
1	Setup screen	Provides menu options for scenario settings and device information such as battery level, software version, and <i>Bluetooth</i> status.
2	Up and Down Arrow buttons	The arrow buttons scroll through menu items in the direction indicated.



ITEM	FEATURE	DESCRIPTION
3	Right Arrow button 	<p>When the title at the top of the screen is highlighted (MAIN MENU or SCENARIO X), the right arrow moves to the next screen.</p> <p>When a menu item within a screen is highlighted, the right arrow moves through the options for each menu item.</p> <p>Note: Settings are saved automatically when you press the UP or DOWN button to move to the next menu item. Do not press the CHECK button until you have finished making your selections on the current screen and want to run the selected scenario.</p>
4	Check button 	<p>Selects the current scenario as the scenario that will be used, and returns to the Main Menu. When the Trainer is turned on with the electrode tray installed, the selected scenario will run.</p> <p>Note: If you press the CHECK button while viewing the Main Menu, the Trainer will save all settings and turn off the setup screen to save power.</p>

The setup screen always opens to the Main Menu. Press the UP and DOWN buttons to scroll through the menu items. To change a selection, use the RIGHT button to scroll through the available options. When the desired option is highlighted, press the UP or DOWN button to scroll to the next menu item. Selections are saved automatically when you scroll to another menu item.

Note: Descriptions of all available options are provided in Setup Options.

Modifying Training Scenarios

The Trainer has two configurable training scenarios. To modify a training scenario, you must move from the Main Menu screen to the desired Scenario screen.

1. Starting in the Main Menu screen, press the UP or DOWN buttons until MAIN MENU is highlighted, and then press the RIGHT button until the desired scenario screen is displayed.

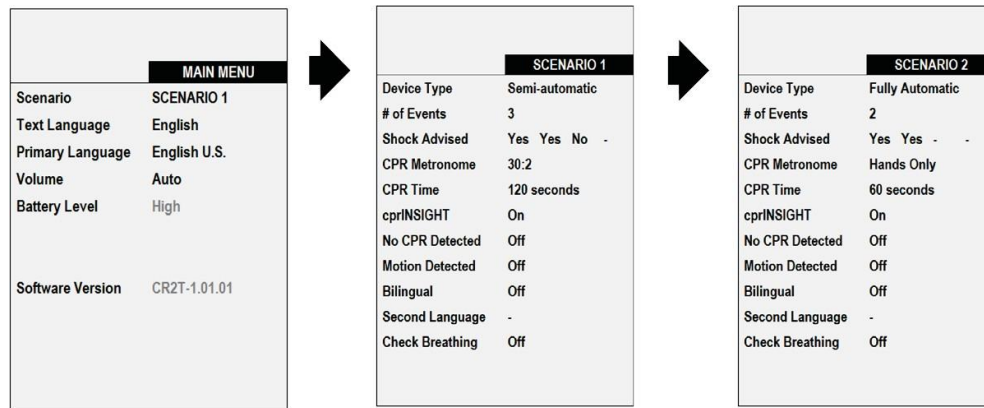

2. When the desired scenario is displayed, press the UP or DOWN button to scroll through the menu items, and use the RIGHT button to select options.
3. When you have set all of the menu items as desired, you can either select the current scenario to run during training sessions, or go to one of the other screens.
 - To select the current scenario, press the CHECK button. This will select the current scenario and return to the Main Menu.
 - To continue without selecting the current scenario, go to the top of the screen and press the RIGHT button until the desired screen is highlighted.

4. To finish setup, go to the Main Menu, ensure the scenario you want to use is selected, and then install the electrode tray and close the lid. The green Power indicator will flash every 6 seconds, indicating that the Trainer is in Standby mode. When you open the lid, the Trainer will begin the scenario you selected.

Note: If you close the lid with the Trainer turned on and the electrode tray out, the Power indicator turns off and the Trainer beeps to simulate a LIFEPAK CR2 defibrillator that is not ready for use.

Each time you exit Setup mode, the settings you selected are saved until you change them again. Each time you restart the Trainer, it will run the last selected scenario.

Setup Options

The following tables explain the available setup options. Some menu items are shown for operator information only and cannot be changed. These are shown in gray table cells, and are also grayed out on the setup screen.

Additional options appear during software updates. These options are explained in Installing Software Updates (on page 32).

The following options appear in the MAIN MENU screen.

MENU ITEM	DESCRIPTION	OPTIONS
Scenario	Sets the scenario that will be used during training sessions.	Scenario 1, Scenario 2
Text Language	Sets the language to be displayed on the setup screen.	All available languages. See Language List (on page 23) for details.
Primary Language	Sets the spoken language that will be used for voice prompts.	All available languages

MENU ITEM	DESCRIPTION	OPTIONS
Volume	Sets the audio volume. The Auto setting automatically adjusts the volume depending on surrounding noise levels.	1, 2, 3, 4, 5, 6, 7, Auto
Battery Level	Indicates the current battery level of the Trainer. See Replacing Batteries (on page 29) for more information.	High, Medium, Low
Software Version	Indicates the currently installed software version for the Trainer.	Not applicable
Available Update	This menu item only appears if a USB software flash drive with a software update is inserted into the USB port.	Version number of available software update
Update Now?	To begin the software update, highlight No and press the RIGHT button to change to Yes. Then press the CHECK button.	Yes, No
Updating...	Indicates the Trainer is installing the software update. Do not press the POWER button or close the lid during this time.	
Passed	Indicates the software update was successfully installed.	
Failed	Indicates the software update failed.	
Rebooting...	Indicates the Trainer is rebooting to complete the software installation.	

The following options appear in the SCENARIO setup screens.

MENU ITEM	DESCRIPTION	OPTIONS
Device Type	<p>Sets the Trainer to simulate either a fully automatic or semi-automatic defibrillator.</p> <p>Note: A fully automatic defibrillator delivers a shock without requiring the user to press the SHOCK button. A semi-automatic defibrillator only delivers a shock if the SHOCK button is pressed.</p>	Fully Automatic, Semi-automatic
# of Events	<p>Sets the number of heart rhythm analysis cycles that will be included in the scenario.</p> <p>When the Trainer is set for Repeat, the scenario goes through events 1, 2, and 3, and then repeats event 4 until the Trainer is turned off.</p>	1, 2, 3, 4, Repeat
Shock Advised	Determines whether each heart rhythm analysis event in the scenario will result in a Shock Advised decision. Select Yes for Shock Advised and No for No Shock Advised.	Yes, No
CPR Metronome	Sets the chest compression to breath ratio to either Hands Only (continuous 'tocks' during CPR time) or 30:2 (instructs the trainee to provide 2 breaths after every 30 'tocks').	Hands-Only, 30:2

MENU ITEM	DESCRIPTION	OPTIONS
CPR Time	<p>Sets the duration of the CPR interval between heart rhythm analyses.</p> <p>Note: The Short setting provides a shortened CPR interval. This setting is not available on the LIFEPAK CR2 defibrillator, but may be useful for demonstration purposes.</p>	Short, 60 sec, 120 sec, 180 sec
cprINSIGHT	<p>During an actual cardiac arrest event, cprINSIGHT™ Analysis Technology enables the LIFEPAK CR2 defibrillator to analyze heart rhythm during CPR. This technology is used only after the first shock has been delivered. Before the first shock, the user is instructed not to touch the patient during analysis. After the first shock, the user is instructed to provide CPR continuously, except during an actual shock. If On is selected, the Trainer will simulate a defibrillator with cprINSIGHT Analysis Technology turned on.</p> <p>Note: cprINSIGHT may not be available in all countries.</p>	On, Off

MENU ITEM	DESCRIPTION	OPTIONS
No CPR Detected	<p>During an actual cardiac arrest event, the LIFEPAK CR2 defibrillator can detect whether CPR is being performed during CPR times. This setup option in the Trainer determines whether the Trainer will simulate a defibrillator that has not detected CPR.</p> <p>If On is selected, the Trainer will behave as though the trainee is not performing CPR when instructed. The voice prompts will change after the first analysis to encourage the trainee to perform CPR.</p> <p>If Off is selected, the Trainer will behave as though the trainee is performing CPR when instructed.</p>	On, Off
Motion Detected	<p>During an actual cardiac arrest event, the LIFEPAK CR2 defibrillator can detect whether patient motion is interfering with the heart rhythm analysis. This setup option in the Trainer determines whether the Trainer will simulate a defibrillator that has detected patient motion.</p> <p>If On is selected, the Motion Detected; Stop Motion voice prompt will be used during the first simulated analysis.</p> <p>If Off is selected, the Trainer will behave as though no patient motion is detected.</p>	On, Off

MENU ITEM	DESCRIPTION	OPTIONS
Bilingual	<p>Determines whether the Trainer simulates a bilingual device.</p> <p>If Off is selected, the Trainer will behave as though only one language is available.</p> <p>If On is selected, the Trainer will behave as though two languages are available. The voice prompts always begin with the primary language which was selected in the MAIN MENU screen. The trainee will then be instructed, in the secondary language, to press the LANGUAGE button if they want to hear the voice prompts in the secondary language. Each time the LANGUAGE button is pressed, the Trainer will switch between languages.</p> <p>Note: After the electrode pads are applied, the Trainer will not switch languages.</p>	On, Off
Second Language	<p>If Bilingual is set to On, this option selects the secondary language that will be used for voice prompts.</p>	All available languages

MENU ITEM	DESCRIPTION	OPTIONS
Check Breathing	<p>Determines whether the trainee will be instructed to check for breathing before resuming CPR after a No Shock Advised decision.</p> <p>If Off is selected, the trainee is not instructed to check for breathing before resuming CPR.</p> <p>If On is selected, the trainee is instructed to check for breathing before resuming CPR.</p> <p>Note: If the language selected is Norwegian, the trainee is instructed to check for signs of life.</p>	On, Off

Language List

Text languages appear in the following order on the setup screen: Danish, Dutch, English, Finnish, French, German, Italian, Norwegian, Polish, Spanish, Swedish, Japanese, Korean, Chinese (Traditional).

Voice prompt (Primary and Secondary) languages appear in the following order on the setup screen: Danish, Dutch, English International, English U.S., Finnish, French, German, Italian, Norwegian, Polish, Spanish, Swedish, Japanese, Korean, Chinese (Cantonese).

Using the Trainer

Before you begin a training session, ensure the selected scenario is set up in accordance with your local protocols or policies.

You do not need a remote control to advance the Trainer through the scenario. When the trainee presses the electrode pads onto the manikin, the Trainer detects the pressure on the pads and automatically advances to the next phase of the scenario.

To begin a training scenario, the electrode tray must be installed with the electrodes and electrode tray cover in place. Close the lid and begin the training session.

Note: The Trainer does not have to be turned on before you begin a training session. However, if you turn the Trainer on and then close the lid, the Power indicator will flash every 6 seconds to simulate a LIFEPAK CR2 defibrillator that is ready for use.

Conduct the training session according to your local protocols.

You can pause the scenario at any time by pressing the POWER button for less than 3 seconds. Press the POWER button again to resume.

The scenario will end when it has completed the preset number of events (heart rhythm analysis cycles). When the scenario ends, prepare the Trainer for the next use.

- Place the electrode pads back on the liners.
- Coil the electrode wire neatly and store it under the liners.
- Reseal the electrode tray cover, starting from the corners.
- Close the lid.

When the lid is opened, the same scenario will start at the beginning. You can also press the POWER button to restart the scenario with the lid open.

Note: If the number of events for the scenario is set to Repeat, the scenario will continue until you either press the POWER button for more than 3 seconds, or close the lid.

Simulating "Device Not Ready" Status

The Trainer can simulate a LIFEPAK CR2 defibrillator that is not ready for use.

1. Remove the electrode tray or unplug the electrodes as shown in Electrode Tray Features (on page 10).
2. Ensure the Trainer is turned on and close the lid. The green Power indicator will turn off and the Trainer will emit an alert tone consisting of 3 beeps. This simulates a LIFEPAK CR2 defibrillator that is not ready for use.

Shutting Down the Trainer

To turn the Trainer off, press and hold the POWER button for at least 3 seconds.

If the Trainer is inactive for 15 minutes, it will turn off automatically. Automatic shutdown is disabled when Repeat is selected for the number of analysis events in the current scenario. The Trainer will continue to run until the lid is closed or the POWER button is pressed for at least 3 seconds.

Note: Always shut down the Trainer when you are finished using it by pressing and holding the POWER button for at least 3 seconds.

Troubleshooting Tips

This section explains problem conditions that you may encounter while using the Trainer.

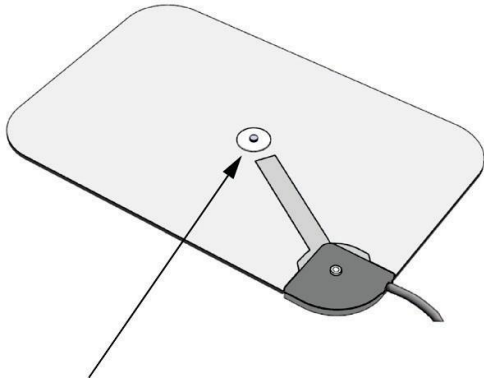
OBSERVATION	CORRECTIVE ACTION
Voice prompts don't start when the lid is opened.	<ul style="list-style-type: none">• Confirm device is on and not paused (LED should be solid green).• Close and re-open the lid.• Press POWER button for more than 3 seconds to turn off device. Then close and re-open the lid.• Confirm electrode tray is securely in place and electrode plug (beneath the electrode liners) is fully inserted.
Scenario does not advance to Do Not Touch Patient prompt when pads are placed on the manikin or other surface.	<ul style="list-style-type: none">• Ensure pads are clean and firmly pressed onto the surface. The sensor on the center back of the pads must be pressed to advance the scenario.  A diagram of a rectangular electrode pad. A small circle with a dot in the center represents a sensor. An arrow points from the bottom-left corner of the pad towards this central sensor. The pad is shown at an angle, with a dark grey electrode plug visible at the bottom-right corner.
Check Pads For Good Contact To Bare Skin or Check Electrode Tray Connection prompt is heard during a scenario.	<ul style="list-style-type: none">• Ensure pads are clean and firmly pressed onto the surface. The sensor on the center back of the pads must be pressed to advance the scenario.
Do Not Touch Patient prompt is heard before pads are removed from the tray.	<ul style="list-style-type: none">• Ensure pads are centered on liners in the electrode tray. Pressure on the sensors could cause the scenario to advance to simulated analysis.

OBSERVATION	CORRECTIVE ACTION
Text on setup screen is in an unfamiliar language.	<ul style="list-style-type: none"> • Scroll down to second item in the Main Menu and press RIGHT button until your language is visible. Press CHECK button to confirm selection and update text.
Setup screen is black.	<ul style="list-style-type: none"> • The setup screen goes dark after 5 minutes of inactivity. Press any display button to wake up the screen at the same point you left it. • After an additional 10 minutes of inactivity (15 minutes total), the Trainer will save your settings and turn off automatically. Press the POWER button to turn the Trainer back on.
Setup screen jumps to Main Menu or turns off.	<ul style="list-style-type: none"> • Avoid pressing the CHECK button until you have completed your selections. The CHECK button is designed to "quick run" your selected scenario according to the following guidelines. <ul style="list-style-type: none"> – If you press the CHECK button while editing a Scenario menu, the device saves and selects that scenario and returns to the Main Menu. – If you press the CHECK button while viewing the Main Menu, the device saves all selections and turns off the screen. – If you press the CHECK button while the text language field in the Main Menu is highlighted, the device updates the screen language to the selected language.

Caring for the Trainer

Follow these instructions to keep the LIFEPAK CR2 Trainer in good working condition.

Replacing Training Electrodes

The reusable training electrodes can be used approximately 50 times. When the adhesive wears out, the electrodes should be replaced. You can order a set of 5 pairs of electrode pads, or a complete electrode tray.

To replace electrode pads:

1. Push the retention pin out from the back of the electrode, and detach the old pad from the connector as shown below.

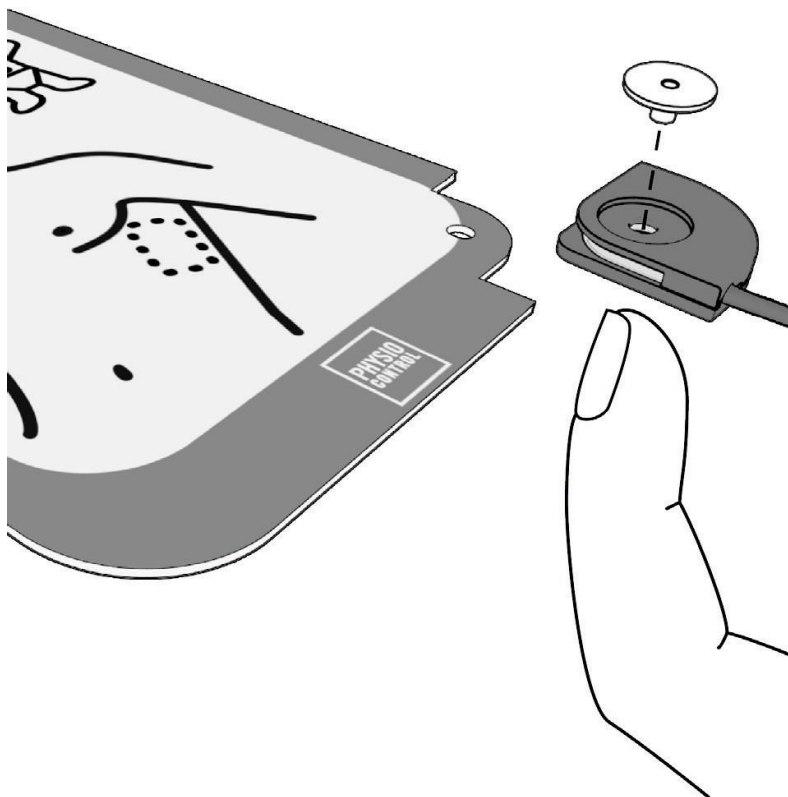

2. Insert the new pad into the connector and insert the pin. Ensure the connector is positioned so that the large-diameter recess for the head of the pin is at the front of the electrode, and the wire exits from the bottom of the electrode.

Note: A spare pin is included with each replacement pad.

3. Remove the disposable liner from the electrode pad and place the pad on the plastic liner in the electrode tray.

To replace the electrode tray:

1. Remove the old tray as described in Entering Setup Mode (on page 13).
2. Insert the new tray.

Replacing Batteries

The Main Menu of the setup screen indicates whether the battery level is high, medium, or low.

BATTERY LEVEL	APPROXIMATE OPERATING TIME
High	60 to 120 hours
Medium	10 to 60 hours
Low	Less than 10 hours

When the battery level is low, you will hear the REPLACE BATTERY voice prompt each time the device shuts down.

When the battery level is low, install 4 new D cell batteries in the compartments shown in the following diagram.

IMPORTANT! For optimal performance, use Physio-Control replacement batteries. Alkaline batteries should always be used in the Trainer.

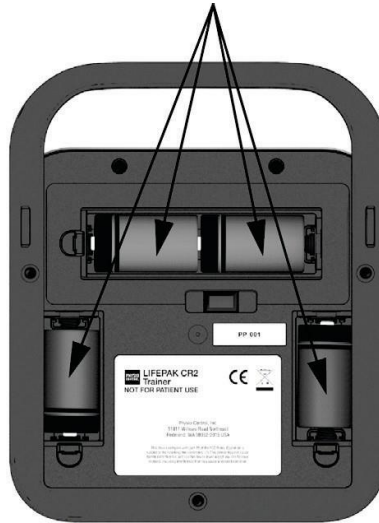

Note: Be sure to replace all 4 D cell batteries at the same time with 4 new batteries.

Cleaning the Trainer

Clean the Trainer by wiping surfaces with one of the following:

- A lint-free, slightly damp cloth moistened with mild soap and water.
- A lint-free, slightly damp cloth moistened with denatured alcohol.

Observe the following precautions when cleaning:

- Do not immerse or soak the Trainer or any of its components.
- Do not use bleach, bleach dilution, or phenolic compounds.
- Do not steam or gas sterilize.

Recycling Information

Recycle the device and its accessories at the end of their useful life.

Do not dispose of this product or its batteries in the unsorted municipal waste stream. Any batteries must be removed from the device and disposed of separately before disposing of the device. At all times dispose of this product and its accessories, including batteries, according to local regulations. Contact your local Physio-Control representative for assistance, or refer to www.physio-control.com/recycling for instructions on disposing of this product.

Preparation

Items should be clean and contaminant-free prior to being recycled.

Packaging

Packaging should be recycled according to national and local regulations.

Accessories and Replacement Parts

The following accessories and replacement parts are available for the Trainer. To order, contact your Physio-Control representative or your local authorized distributor.

DESCRIPTION	CATALOG NUMBER
Electrode tray (includes training electrode pads, plug, and tray cover)	11250-000145
Replacement training electrode pads (set of 5 pairs with 10 retention pins)	11250-000140
Electrode tray cover with red handle	11250-000139
Replacement batteries (set of 4)	11141-000166
3-pack battery compartment doors	21250-000003
LIFEPAK CR2 Trainer bag	11260-000048
Training mat	11250-000144

Software Updates

Software updates for the LIFEPAK CR2 Trainer may be released occasionally. To find out whether the software in your Trainer is up to date, first determine which software version is currently installed. Remove the electrode tray and turn on the Setup Screen. Write down the Software Version shown at the bottom of the Main Menu, and then contact your Physio-Control representative or local authorized distributor to find out whether that software version is current.

Installing Software Updates

Software updates are delivered on a USB flash drive. To install the software, follow these steps.

1. Insert the flash drive into the USB port on the bottom of the Trainer.



2. Turn on the Trainer, remove the electrode tray, and view the Setup Screen. Take note of the current software version displayed at the bottom of the Main Menu.

MAIN MENU	
Scenario	SCENARIO 1
Text Language	English
Primary Language	English U.S.
Volume	Auto
Battery Level	High
Software Version	CR2T-1.01.01
Available Update	CR2T-1.02.02
Update Now?	No

Current version

New version

3. Available Update should appear at the bottom of the Main Menu, followed by Update Now? Scroll down to Update Now?. Use the RIGHT button to select Yes, and then press the CHECK button. The screen will display Updating and show the status as percent complete.

Note: Software updates may take up to 15 minutes, depending on the type of update.

4. When the software update is complete, you should see Passed, followed by Rebooting. After the Trainer reboots, Passed should be displayed below Update Now?

If the software update is unsuccessful, you will see Failed below Update Now? See Troubleshooting Tips for Software Updates (on page 35) and try again. If the update is still unsuccessful, contact your Physio-Control representative or local authorized distributor for assistance.

5. To verify the update was successful, confirm the new software version is displayed in the Main Menu. When you are finished, remove the flash drive from the USB port.

Troubleshooting Tips for Software Updates

This section explains problem conditions that you may encounter while updating the software.



OBSERVATION	CORRECTIVE ACTION
Update Available message does not appear when the USB flash drive is inserted.	<ul style="list-style-type: none">• Ensure the flash drive is fully inserted.• Ensure the battery level is High or Medium. The Trainer will not begin a software update with a low battery.• Ensure the electrical contacts in the USB port are clean. Turn the Trainer off, insert and remove the USB flash drive several times, and then turn the Trainer back on.
Screen goes black during a software update and device will not turn on.	<ul style="list-style-type: none">• Press and hold the POWER button for more than 10 seconds.
Software update fails.	<ul style="list-style-type: none">• Ensure the files on the flash drive have not been altered, and no other files have been added. The files on the flash drive are a set that must be used together.

Specifications

CHARACTERISTIC	DESCRIPTION
General	Device designed for low impact, low stress environments. For use in temperature-controlled areas protected from precipitation. Capable of withstanding heavy usage and prolonged periods of operation.
Physical Characteristics	Height: 27.2 cm (10.7 in) with handle Width: 21.8 cm (8.6 in) Depth: 8.6 cm (3.4 in) Weight: 1.8 kg (3.9 lb) with batteries
Batteries	6 volts/4 cells, range 3.3–6.6 Vdc Four non-rechargeable D-cell alkaline batteries. New batteries will provide not less than 100 hours of continuous operation at volume 4.
Operating Temperature	3° to 38°C (37° to 100°F)
Storage Temperature	-10° to 60°C (14° to 140°F). Remove batteries for storage. After storage at extreme temperatures, 2 hour recovery period is required.
Water Resistance	Spillage resistance per IEC 60601-1, 11.6.3.

Symbols

The symbols in the following table may be found on the device or its packaging.

SYMBOL	DESCRIPTION
	Indicates compliance with the EMC Directive 2004/108/EC and the RoHS Directive 2011/65/EU.
	Do not dispose of this product in the unsorted municipal waste stream. Dispose of this product according to local regulations. See www.physio-control.com/recycling for instructions on disposing of this product.



Physio-Control, Inc.
11811 Willows Road NE
P.O. Box 97006
Redmond, WA 98073-9706 USA
Tel 425.867.4000
Fax 425.867.4121
www.physio-control.com



Physio-Control, Inc., 11811 Willows Road NE
Redmond, WA 98052



Physio-Control Operations Netherlands B.V.
Galjoenweg 68, 6222 NV Maastricht
The Netherlands



©2016 Physio-Control, Inc.

 3326581-000

All names herein are trademarks or registered
trademarks of their respective owners.

Specifications are subject to change without notice.

Publication Date: 03/2016